

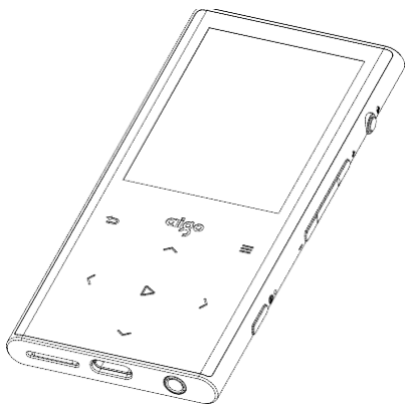

DIGITAL MUSIC PLAYER

Instruction Manual

M1



In order to fully enjoy your music player, be sure to read this manual carefully before you use your device for the first time, and please keep it for your future reference.



Freedom in
TECHNOLOGY,
Freedom in
LIFE.

Table of CONTENTS

ANNOUNCEMENT	2
COMPANY INFO.....	3
PRECAUTIONS	4
CONTENTS	5
FEATURES	6
PARTS.....	7
CONTROLS	8
PLAYING MUSIC	9
PLAYING VIDEOS	10
FMRADIO	11
PICTURES	12
E-BOOKS.....	12
FILE MANAGEMENT.....	13
PEDOMETER	13
BLUETOOTH	14
SYSTEM SETTING.....	15
TROUBLESHOOTING	17
SPECIFICATIONS	18
NOTES ON ENVIRONMENT PROTECTION ..	20
SERVICE TERMS	21

ANNOUNCEMENT

- A) Thank you for purchasing the aigo® M1 digital music player by Beijing EROS Technology Co., Ltd. Be sure to read this manual carefully before you use your device for the first time. If you start using the device, the company assumes that you have already read this guide carefully.
- B) Please fill the “Acknowledgement of Three Guarantees” within a month after your purchasing and deliver it to our company to register, so that we can provide better services for you.
- C) The contents covered in this manual is updated to the latest during editing. If any change is made to the product later, we are sorry that this manual fails to inform you. If you have any questions or issues with your M1 digital music player, visit the official website of Beijing EROS Technology co., ltd: **www.eroshifi.com**.
- D) The power jack of aigo M1 is designed for charging its built-in battery. Charging is not guaranteed with homebuilt or modified computers. Operation with a USB port extended with a USB hub is only guaranteed when a self-powered USB hub that carries an authorized logo is used. The company bears no responsibility for any consequence resulted from unauthorized ways of

charging, malfunction of the hardware and data loss for example.

- E) Do not repair or take apart the music player by yourself. Or we shan't provide you with normal after-sale service.

Company Information

Beijing EROS Technology Co., Ltd (EROS) is an aigo Group company producing high-end video & audio entertainment products.

As one of the most promising high-tech enterprises in China, aigo adheres to the concept of "autonomous science and technology, free life", and is committed to providing high-tech products and IT technical solutions with advanced technology, superior performance and excellent quality for consumers. aigo has been investing in technology research and development in key areas during the 25 years since its establishment. Among them, sound acquisition, playback, and power supply-storage systems developed in audio field have successfully completed the recording and storage tasks of Shenzhou spacecrafts twice. Up to now, the total number of aigo's patent applications has exceeded 180, and 21 national patented technologies have been reserved. Its technology level is in a leading position in China.

In recent years, with the gradual popularization of personal consumption in the field of audio-visual entertainment technology and products, aigo Electronics Technology Co., Ltd. of aigo Group has launched a new strategic system, which separates the original aigo intelligent audio projects and operates them independently. Beijing EROS Technology Co., Ltd (EROS), therefore has been established. It adheres to aigo's technical accumulation, brand effect in audio field in the past 20 years, as well as its high-end audio brand EROS' strength of innovation, research and development and production in the field of audio and video entertainment, conforms to the developing trend of digital technology of audio-visual entertainment, and grows roundly to audio, video, entertaining interconnection and other directions.

Technology takes its customers as the bench mark, in a user-friendly perspective, bringing the most fashionable digital products of audio-visual entertainment to them. EROS will stick to autonomous innovation and independent brand, consolidate and expand its strong brand effect and sterling reputation in the market. In the future, with aigo and EROS' brand effect, excellent researching-developing systems and its multiple experiences in Chinese market, EROS will grasp the great opportunity of market reform of high-end audio consumption, try to achieve rapid growth, and become a popular, respectable and first-class international

high-tech enterprise in the industry.

PRECAUTION S

This product is a sophisticated electronic device; while using it, please pay attention to the following warnings and notes:

- 1 Be sure not to short-circuit the terminals of your Walkman with metallic objects; keep it away from humid or smoggy locations;
- 2 Do not take apart or modify the device;
- 3 Do not clean your earphones with any caustic or abrasive cleaner;
- 4 Do not spill water on your music player;
- 5 Do not put any heavy object on top of your device;
- 6 Do not place the device in fire. Avoid direct sun exposure, low-temperature environments and high-temperature environments;
- 7 Do not apply a strong shock to it;
- 8 We suggest you turn down the music player before using the earphones. Turn up your device after you start listening gradually to a proper level. In order to protect your hearing, please do not raise the volume too loud (According to doctors, being exposed to loudness for a long time will do harm to the listeners' hearing.). When tinnitus occurs, please turn the volume down, or cease usage;

- 9 Be sure to store it safely, and avoid children's using it in case of any incident or dropping;
- 10 Heat may build up in your device while charging if it is plugged into a computer. The charging process normally lasts for 4 hours. We suggest you disconnect the device from the USB port once the charging is finished. Do not charge the battery for an extended period of time.
- 11 Do not take apart or modify the device by yourself, or the guarantee fails. If any questions come about, please contact the dealers;
- 12 Changes made to the product after this version of instruction manual is not to be informed. If the customer finds that this instruction manual says differently about the device you own, please refer to the actual product;
- 13 Please do not wear earphones while doing jobs that require hearing concentration, including driving, riding and operating machines;
- 14 Notes on charging batteries:
 - A A lithium-ion rechargeable battery is built into your music player. The first times of charging must last 4 hours at least. Deplete the battery every time before charging it to extend battery life;
 - B We suggest that users charge for half more hour after the battery is fully charged in order to

- make the device plays longer;
- C The lithium-ion battery shall be replaced by the service staff. Customers shan't replace it themselves (Warning: an improper replacement risks explosion. The replacing battery must be of the same type or of the same effect); in order to protect the environment, please send the used batteries to professional agencies to dispose.
 - D Battery life may depending on conditions of use and time of production.

15 Charging: this device can only be charged through a USB port of computers or with a 5V1000mA adapter that meets the national standard. No matter the device is on or off, as long as it is connected to an adapter, the charging process is on. During this process, the product can get warmer to some degree, which is normal.

16 The actual operations on this product, due to the updating of software, might be different from instructions on this manual. Please refer to the product purchased. The instruction manual serves only as a guideline.

CONTENTS

M1 music player(1)

USB cable(TYPE C)(1)

Instruction Manual (The “Acknowledgement of Three Guarantees” included) (1)

Certificate(1)

***Please refer to the actual accessories and manuals supplied in your purchased package.**

FEATURES

- 1、 2.4inch TFT color HD display;
- 2、 Integrated toughened glass panel, smooth and natural;
- 3、 Ultra-thin all-metal fuselage, full of texture;
- 4、 BT4.1 Bluetooth transmission, easy to connect Bluetooth headphones, Bluetooth speakers and even cars;
- 5、 Highly sensitive capacitive touch button, perfect control experience;
- 6、 Professional recording function, one-click recording, comparable to recording pen;
- 7、 Built-in horn that supports external playing;
- 8、 TypeC USB cable, faster and more stable ;
- 9、 TF card storage extension. Highest capacity reaches 128GB;
- 10、 Date, clock display, and alarm clock are available;
- 11、 FM and campus channels;
- 12、 Pedometer function, exercise partner;
- 13、 Supports AMV,AVI video, e-books and picture playback;
- 14、 Supports repeat, variable speed playback, which makes it easier to learn;
- 15、 Music in mp3, wma, wav, ape, flac is

readable;

16、 Supports lrc lyrics and album cover display;

17、 Ultra-long playback time, continuous playback up to more than 30 hours.

PARTS

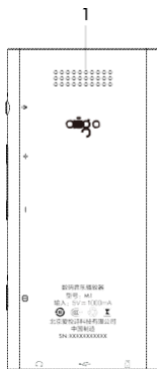

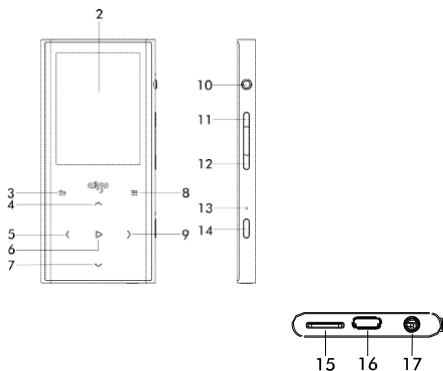

No.	Description	No.	Description	No.	Description
1	Loudspeake	2	Display	3	BACK button
4	Up button	5	Last song/REW	6	Pause/Play/Confirm
7	Down	8	Menu	9	Next song/
10	Record button	11	VOL(Volume)+	12	VOL(Volume)-
13	Recording	14	POWER	15	Card slot
16	Type C jack	17	Headphone jack		

CONTROLS

Turn on/off:

Press and hold the power button for 2 seconds to turn your device on. Press and hold again to turn your device off. Press shortly, and the screen will go blank. Press it again, and screen works again.

Insert/unplug TF card:

Insert the TF card into the slot, and it will lock the card automatically. When unplugging, push the TF card into the bottom of the slot and release it. The card will bump out so that you can take it away.



It is suggested that high speed TF cards of class 10 and above should be selected as far as possible to ensure the fluency of music appreciation.

Charging: Please check the power on turning your device on. If the power is running out soon, please charge the device in time in order to use it. When the system enters a state of low power, it will remind you and turn off automatically.

1. **Charging with an adapter:** Before charging, connect the adapter to power sources, and then plug the USB cable to the adapter, the other end of the

USB connected to the Type-C port of the device. USB-based charging takes approx. 120 minutes. (Please charge with a 5V1000mA adapter that meets the national standard.)

2. Charging with a computer: Connect your Walkman to a computer via USB to charge the Walkman or transfer data. The music player can be used as a storage disk at the same time. (Charging the product via USB port of computers will take longer than with an adapter.)

⚠ The charging time differs depending on the power output conditions of computers' USB ports. It is suggested that while charging via PC USB, the device should be turned off, in order to speed up the charging process.

⚠ Your devices may become hot while charging. This is not a malfunction.

PLAYING MUSIC



From the Home menu, select [Music].

Select the desired search method and items until a song list appears, and then select the desired song.

Press the PLAY button. Playback starts and the music playback screen is displayed. To pause playback, press the button again. Shortly press the MENU button to enter the music setting. Press UP/DOWN button to select menu and press the PLAY button to confirm.



1. Playback modes

a. Sequential playback: Play songs in the playback range in sequential order.

b. Single repetition: Play one single song repeatedly.

c. Repeat playback: Play songs within a playback range repeatedly.

d. Shuffle playback: Play songs in the playback range in random order.

c. A-B Repetition setting

A-B MODE: During the playback, choose the A-B MODE then press the PLAY button to enter the setting of A and B of your repeated recording. Shortly press the NEXT button to set the beginning of the repeated recording A, and press shortly again to set the end B. Now the device starts repeating. Press the NEXT button again to cancel repetition. To reset, press the LAST button.

Repeating times: users can set how many times to play A-B(The system setting is 5.)

Repeating interval: users can set the interval between the repetitions of A-B. (The system setting is 1 second.)

2. Volume setting

Equalizer: Six different styles of EQ options (rock and roll, funk, Sir hip- pop, classical, electronic music).

Variable speed playback: Users can change the speed of playback.

(Note: 1.Speed changing only available for music inmp3 and wav formats. 2. The options in the equalizer do not support variable speed playback. Even if the variable speed is already set, the system will automatically turn it off as long as the user enters the equalizer menu system. At this point, if the user presses the return key or when the system automatically returns to the playback interface, and completely exits the equalizer variable speed function, the equalizer variable speed function will continue to be turned on.

3. Deleting

Select “Delete” and press the PLAY button to delete the

current music played.

PLAYING VIDEOS

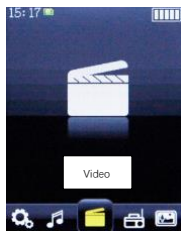

1. Select the desired search method and items until a video list appears, and then select the desired video.

Press the PLAY button. Playback starts and the video playback screen is displayed. To pause playback, press the button again.

2.Video formats and specifications:

Video formats: the player only supports AVI and AMV.

Resolution ratio: 240*320 Pixels.

FM RADIO



1. From the Home menu, select [FM Radio]. Press the PLAY button to enter the FM radio. (You cannot listen to FM radio without connecting headphones as the cord of the headphones works as the antenna.)
2. Press the MENU button and press the UP and DOWN to select the menu and press the PLAY button to confirm.
3. Please use [Auto Preset] to automatically search for and preset broadcast stations that can be received in your area. (FM Frequency range: 87.5-108.0MHz)
4. When the Auto Preset is finished, you can press the PLAY button shortly to switch the preset stations.
5. Recording with FM Radio: While listening to the radio stations, press the MENU button and select [Start to record with the FM Radio]. You can record the desired radio programs and press the RECORD button to store them. (The recording files

of the FM Radio can be found and played in the menu of “FM recording”)

6. Select the “Station Frequency” and you can choose from common frequencies or the Japan frequencies (Campus frequencies).
7. To turn off FM radio, press the BACK button and select “YES”. If you choose “NO”, the radio will play in the background.

PICTURES

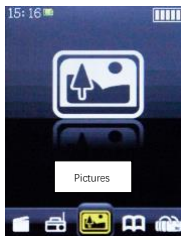

1. Press the PLAY button to enter the pictures.

Press the UP and DOWN to select the desired picture and press the PLAY button to start viewing.

2. Picture formats and specifications:

Video formats: the player only supports JPG and BMP.

Resolution ratio: 240*320

E-BOOKS

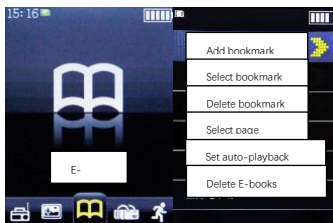

1. Press the **PLAY** button to enter the E-books.
Press the **UP** and **DOWN** to select the desired E-book files in txt format and press the **PLAY** button to start reading.
2. Press the **PLAY** button to turn pages.
3. Press the **MENU** button and press the **UP** and **DOWN** to select the needed menu and press the **PLAY** button to confirm.
4. This product only support E-books in **TXT** format.

FILE MANAGEMENT



1. Press the PLAY button to enter the FILES in order to check up.
2. Press the UP and DOWN to select the needed FILE and press the PLAY button to confirm.
3. Press the BACK button to exit.



Before you enter the FILES, please insert the TF card with files downloaded.

PEDOMETE

R

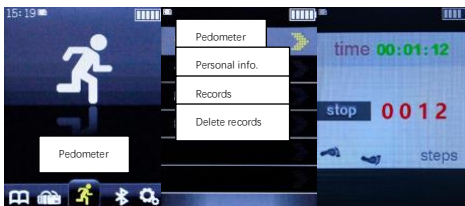

1. Record steps: after pressing the PLAY button to enter the pacemaker, select the pedometer and press the PLAY button to confirm that the step recording begins.
2. Save steps: in the state of recording steps, press the PLAY button first and then press the BACK button to select “YES”. Save the result and end the recording.
3. In the pedometer menu, you can maintain your personal information, query and delete the previous step

BLUETOOTH

1. Press the PLAY button to enter the Bluetooth mode.
2. Bluetooth switch control: press the UP and DOWN to select Bluetooth switch control, press the PLAY button to confirm and select Bluetooth on.
3. Search for devices: open the surrounding Bluetooth device, press the UP and DOWN buttons to select the desired device. When you find the Bluetooth device on the display screen, names of the found Bluetooth device and the saved devices previously connected to the music player will present themselves. Then press

the PLAY button to confirm the connection and match. After the connection, press the UP and DOWN buttons to select "play via Bluetooth" to enter the music list and press the PLAY button again to play music via Bluetooth.



This product applies Bluetooth with signal transmission function (which can only connect to Bluetooth speakers, Bluetooth headphones, and do not support connection to mobile phones).

SYSTEM SETTING

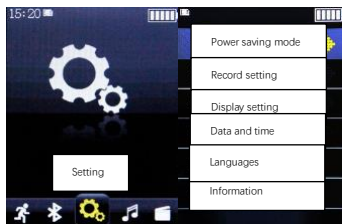

Press the PLAY button to enter SETTING. Press the UP and DOWN to select the desired menu and press the PLAY button to confirm.

1、Timing shutdown in Power Saving Mode: after setting the timing shutdown, the machine will automatically shut down at the specified time.

The machine provides step-by-step options for "off" and " $1 \leq 99$ " minutes.

Idle shutdown: when the device is not in the playback state and no-operation state, when it reaches the set idle shutdown time, the device will automatically shut down to save electricity. This device provides six options: off, 5 minutes, 10 minutes, 15 minutes, 30 minutes, and 60 minutes.

2、Recording setting



Start recording: Press the **PLAY** button to enter the recording mode. Press the **RECORD** button for a while to save the records. (Anytime when the device is on, if you press the **RECORD** button for a while, you can start recording and saving.)

Recording library: Press the **PLAY** button to enter the recording library. Press the **UP** and **DOWN** to select the desired record and press the **PLAY** button to play it right away.

Record format: **MP3** and **WAV**.

Recording Setting: you can select recording bit rate effects with different qualities and avr mode. (The recording will be paused when the microphone does not detect an external sound after the avr mode is selected, and the recording will continue after the sound is detected.)

3. Display Setting

Backlight timer: When it comes to the specified time, the back light will be automatically inactivated, so as to play the role of power saving in the screen. Or you can shortly press the POWER button to enter the black screen mode.

Brightness: Select the backlight level according to your environment.

4. Date and time

The time and date can be set in this feature. Press the UP and DOWN buttons to adjust the number rolling, and press them to switch options. Press the PLAY button to confirm and save the settings.

5. Language: Press the PLAY button to enter LANGUAGE SETTING. Press the UP and DOWN to select the desired language and press the PLAY button to confirm.

6. Information

Enter the Information menu to check up the software info. and the disk space.

7. Screen protection

Turn off the screen: Black screen status after holding the screen.

Digital clock: There will be numbers indicating date and time after the device enters screen protection status.

8. Formatting the device

Confirming to format the device would delete all the files within the built-in memory card. ◦

9. Resetting to the factory settings: Users can restore the player to the original factory settings. At that time, all the information of customers' setting will be cancelled and reset to the default state. (The file in built-in storage card will not be lost.)

TROUBLESHOOTING

Unable to boot	Check if the battery is charged enough. Press the POWER for 2s to turn the device on. If it still doesn't work, please contact the service staff.
----------------	--

No sound	Check if the volume is too low. Whether the earphones are plugged right or broken. Make sure that the earphones are types supported by this product. Check if the music files are broken or in wrong formats.
Unable to download	Check if the device is connected to a computer properly. Whether the TF card is damaged or lacks room for storage.

SPECIFICA

TIONS

Product model	aigo M1
Dimensions	107*50*8mm
Languages	Simplified Chinese, traditional Chinese, English
Mass	70g
Panel	2.4 inch TFT 240*320 Pixels
Button keystrokes	Highly sensitive capacitive
Battery	500mAh/3.7V lithium-ion battery
Charging specification	5V/1A input
Charging time	<4 hours
Bluetooth version	4.1
Total harmonic distortion	<0.05%
noise-signal ratio	97dB@1KHz, ±3dB
TF card extension	≤128GB
Audio format	MP3 (32kbps-320kbps) WMA(32kbps-320kbps) APE(800kbps-1000kbps)(Doesn't High) WAV (PQM 32kbps-1536kbps)
Video format	AVI/AMV (240*320)*
Recording format	WAV, MP3*

E-book format	TXT (10MB and below)
USB port	TYPE C, USB2.0 and charging
Analog output	3.5mm analog output
Loudspeaker	1W*1 4ohm
Working temperature	-5 to40 degree
OS supported	Windows XP/Vista、Win7/8.1/10
Mac OS 1	
Playback duration	Normal standard* 30h+

- * The audio index shown in this table is for reference only. Due to the delicate differences in electronic components of the product, there will be slight differences in audio parameters. Please refer to your purchased device.
- * For music files that this specification table doesn't cover, there may be phenomena of no recognition or no play. Please use audio files within the specification range to play.
- * Normal standard: Closed screen, medium volume (15) and for music of 44.1KHz/16Bits in APE format.
- * Because there are many kinds of song format conversion software on the network, some of them do not fully conform to the format standard. Therefore, this player does not fully guarantee that songs within the specification range all play perfectly.
- *Recording format:
WAV (1536kbps 48KHz 16bit) (1024kbps 32KHz 16bit)
(768kbps 24KHz 16bit) (512kbps 16KHz 16bit) MP3 (192kbps 32KHz) (128kbps 32KHz) (64kbps

16KHz) (32kbps8KHz)

*Video format:

The device only supports video files that are Motion-JPEG coded in AVI format or AMV. The resolution ratio is less than the QVGA, frame rate less than the 30fps and code stream less than 352.80 kbps.

*Reminder about Bluetooth playback:

When you play via Bluetooth, files compressed to High by ape are not supported.

(When playing via Bluetooth, such as playing high-quality music, there might be a jam phenomenon.)

*Reminder about the cables: When charging and transmitting data of this product, please use the cable packed with this device. If the main device also has a Type-C port, please use double Type-C interface OTG cable, otherwise it won't work

NOTES ON ENVIRONMENT PROTECTION

According to the measures for the prevention and control of pollution of electronic products and the related requirements of the law of the Office of pollution Prevention and Control of Electronic Information products (SJ/T11364-2006), the names and contents of toxic and harmful substances or elements in the products are expressed.

Toxic and harmful substances or elements

Parts	[Pb]	[Hg]	[Cd]	[Cr(VI)]	[PBB]	[PBDE]
PCBA	1	1	0	1	0	0
Mechanism parts	0	0	0	X	0	0
Panel	0	0	0	0	0	0
Cables	0	0	0	0	0	0
Battery	0	0	0	0	0	0
Package	0	0	0	0	0	0
Accesso	0	0	0	0	0	0

0 indicates that the content of the toxic and harmful substance in all homogeneous materials of the component is below the limit specified by SJ/T11363 in 2006.

X indicates that the content of the toxic and harmful

substance in at least one homogeneous material of the component exceeds the limit specified by SJ/T11363-2006.

Note: 90% of the components of this product are made of non-toxic and harmless environmental protection materials, and the components containing toxic and harmful substances or elements are unable to be replaced due to the limitation of present technology.

SERVICE

TERMS

EROS TECHNOLOGY STANDARD WARRANTY

Dear customers: Hello! Thanks for purchasing and using aigo digital music players. In order to protect your legitimate rights and interests, Beijing EROS Technology Co., Ltd. (hereinafter referred to as EROS Technology) make our standard service warranty to you as bellow. The warranty includes four parts: Sunshine Service Commitment, special reminder, service process and descriptions. If our services are in need, please refer to this warranty.

Sunshine Services Commitment by EROS TECHNOLOGY

EROS Technology has solemn words:

A、The “three guarantees” commitment period of this product shall take effect from the date of purchase, and the date shall be based on the date recorded in the official purchase invoice. The voucher for your receiving of our services is a valid “three guarantees” paper with complete

official purchase invoice and customer information stamped by EROS Technology or dealers.

B、 The “three guarantees” duration of this product: For a period of fifteen (15) days from the original date of purchase of the product, EROS will, replace with new or refurbished product, product determined to be defective. For a period of twelve (12) months from the original date of purchase of the product, EROS will repair the product determined to be defective. For a period of one (1) month from the original date of purchase of the product, EROS will supply new or refurbished replacement parts in exchange for parts determined to be defective.

C、 Under the condition of normal use and maintenance of the purchased products, during the “three guarantees” commitment period, the products can enjoy free service after being tested and determined by the EROS Technology and technical personnel as long as the defects are due to the failure caused by the device itself.

D、 For a period of seven(7) days from the original date of purchase of the product, the customer can return the product for a full refund. If the product malfunctions within seven (7) days from the original

date of purchase, you can choose to repair, exchange or return.

- E、 During the “three guarantees” commitment period, if your device is repaired more than twice, you can return the product for a full refund. During the “three guarantees” commitment period, if your device malfunctions and is repaired by our service staff for more than twice, and still doesn't work well, you can choose to repair or exchange the product.

Special Reminder:

- A. Please assist the seller to complete the Acknowledgement of Three Guarantees, ask for a formal purchase invoice and take good care of it, and be sure to bring it with you every time you receive the service! If you are unable to produce an official purchase invoice, a valid Acknowledgement of Three Guarantees, or your recorded information do not conform to the faulty equipment, or are altered, blurred and unrecognizable.

Then our “three guarantees” commitment period of the faulty equipment starts from one month after the production date represented by the serial number of the product.

B. Product in the following situations is not included in the “three guarantees” services:

1. The date of its malfunction exceeds the duration of this warranty;
2. No formal purchase invoice or valid Acknowledgement of Three Guarantees (except those according to their serial numbers to judge);
3. Acknowledgement of Three Guarantees changed and blurred or the serial numbers recorded disagree with those on the product;
4. Failure to use, maintain or keep in accordance with the requirements of the use of the product, resulting in damage;
5. Man-made damage;
6. Damage caused by force majeure;
7. Repaired, altered, modified or disassembled by service personnel not authorized by EROS Technology.

C. In the event of OS and software failure, EROS Technology can provide free software recovery service during the “three guarantees” period, but it does not serve as the basis for the implementation

of EROS Technology Sunshine Service Commitment. The failure of auxiliary parts or other parts of the equipment does not serve as the basis for the fulfilment of service commitments for the main device.

D. EROS Technology shall not be liable for special, accidental or indirect losses of users and dealers

E. EROS Technology shall not be liable for incidental damages or the damages in the aftermath, expected losses in property, data or privacy, or damages due to work with the device and its malfunctions during work. Meanwhile, the repairing of faulty products will cause data loss. Please back up in advance. EROS Technology shall not pay for any loss due to data loss during usage or the repairing services, or for any other indirect losses.

- F. When you purchase this product, if the seller makes some other commitments beyond this commitment, please ask the seller for written proof to ensure that the seller is responsible for these additional commitments, for which EROS Technology shall not be responsible.
- G. For your good and to prevent your waiting for repair, EROS Technology Service Center shall choose product replacement to provide warranty services for faulty products that fall within the scope of warranty. Such replacement no more than twice within the duration of the “Three Guarantees” shall be regarded as maintenance, and the “Three Guarantees” period after replacement shall not be extended. If you disagree with this approach, be sure to repair the original product instead of replacing it.
- H. Others:
1. All EROS Technology products are delivery-to-repair services. We do not provide door-to-door services, and do not bear the transportation costs incurred in the process of delivery and repair; EROS Technology Service Center does not provide download services including, but not limited to, downloading of

audio, video, software, firmware, etc.; it does not provide any upgrade services other than the upgrade services officially promised by the service center.

2. The date of failure of the product shall be the date of its delivery to the EROS Technology Customer Service Center.
3. When you deliver the repair product, be sure to leave a telephone number that is convenient for your contact so that you can be informed to pick up the device in time after the repair. Please take it from the receiving point within one week after receipt of the notice. If you do not take it for more than three months, the seller who is responsible for providing the service will no longer be responsible for custody (except as previously agreed between the user and the seller).
4. If your product meets the return conditions of the “Three Guarantees” promised, and you do not agree to change or repair, please bring your seller the faulty device, all its parts and the failure certificate (maintenance service form) issued by the EROS Technology Service Center when you choose to return the goods. The goods will be returned for full

refund at once in accordance with the purchase price (the price specified in the official invoice).

5. aigo offers 12 months quality-related warranty only for the purchases from official stores. Any unauthorized disassembly or repair will not be covered by our warranty.

Online Support

Email address: customerservice@aigo.com

Facebook: <https://www.facebook.com/AigoOfficial/>

Instagram: <https://www.instagram.com/AigoOfficial/>

Twitter: <https://twitter.com/officialaigo/>

SERVICE PROCESS:

- A. You can choose to contact your dealers directly.
 - a. EROS` dealers will help you to test your device and solve problems.
 - b. EROS` dealers won`t be able to test your device and solve problems, they will send your device back to the EROS` service center. Technical staff in EROS` service center will test your device and solve problems.
 - c. You can choose to take your device to the local EROS` service center directly. Technical staff in EROS` service center will test your device and solve problems.

If you have any questions with the service process, or if you are not satisfied with the service process, or if the dealer has any misconduct, you can call the complaining hotline 400 / 610 / 6666.

Announcement:

- A. This commitment applies only to products purchased and used within the territory of the People's Republic of China (except Hong Kong, Macao and Taiwan). If laws of the country state otherwise, this commitment shall be implemented in accordance with the corresponding laws.
- B. Unless expressly stated in this warranty service commitment, EROS Technology does not make any other expressed or implied warranties, including implied warranties for the marketability of the product and the applicability of a particular purpose
- C. During the free guarantees, EROS Technology or its authorized service organization has the ownership and disposal rights of the replaced faulty parts.
- D. The final right of interpretation of the above commitments belongs to EROS Technology.

The copyright of all works preset in this product shall be owned by the corresponding copyright owners and

protected by the Copyright Law of the people's Republic of China. Sales of this product by our company does not represent the transferring or granting of any rights related to the copyright of the works to the users.

Notes for Warranty

(Acknowledgement of Three Guarantees)

- A. Please take good care of this acknowledgement and show it when repair.

- B. This acknowledgement is invalid without getting stamped by EROS Technology or dealers

- C. Acknowledgement of Three Guarantees and the receipt are all considered invalid if not filled in details. Please make sure during the purchase that they are carefully filled and deliver the receipt back to EROS Technology service center for us to provide you with services later.

D. NOTE:

This equipment has been tested and found to comply with the limits for a Class B digital device, pursuant to part 15 of the FCC Rules. These limits are designed to provide reasonable protection against harmful interference in a residential installation. This equipment generates uses and can radiate radio frequency energy and, if not installed and used in accordance with the instructions, may cause harmful interference to radio communications. However, there is no guarantee that interference will not occur in a particular installation. If this equipment does cause harmful interference to radio or television reception, which can be determined by turning the equipment off and on, the user is encouraged to try to correct the interference by one or more of the following measures:

- Reorient or relocate the receiving antenna.
- Increase the separation between the equipment and receiver.
- Connect the equipment into an outlet on a circuit different from that to which the receiver is connected.
- Consult the dealer or an experienced radio/TV technician for help

Changes or modifications not expressly approved by the party responsible for compliance could void the user's authority to operate the equipment.

This device complies with Part 15 of the FCC Rules. Operation is subject to the following two conditions:

- (1) this device may not cause harmful interference, and
- (2) this device must accept any interference received, including interference that may cause undesired operation.



www.aigo.com

Beijing EROS Technology Co., Ltd

Address: No. 1 building, no. 26, west li, Lianhuachi, Haidian district, Beijing, 321

Official website: www.eroshifi.com